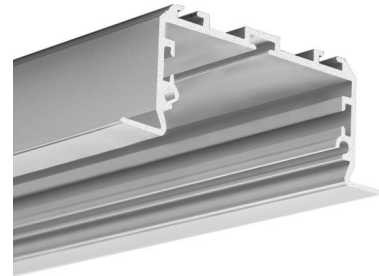

PRODUCT DESCRIPTION

- Simple mounting that does not require plastering and painting the surface afterwards
- Line of light

FINISH :

Silver anodized 

Fill empty fields

Product nr.	
Fixture type	
Company	
Job name	
Date	

TECHNICAL SPECIFICATION

Application

- for creating serviceable straight and sectioned LED lighting fixtures, mounted in drywall

Assembly

- uses dedicated KMA springs

Additional information

- line of light obtainable with the LIGER-50 cover and LED strips with a minimum of 120 LED /m
- designed for up to four 10 mm wide LED strips
- the cover is evenly illuminated with four LED strips, with fewer strips shadows appear on the cover
- LARKO-50 profile is equipped with ZM sockets on the inside and outside. ZM connectors used to connect profiles lengthwise are easily accessible even after mounting the profile in the ceiling. External sockets are used to mount KMA springs.

Recommended number of springs (assembled in pairs) depending on the length of the profile:

Profile length	1 m	2 m	3 m
Number of KMA springs	6	10	14

- the groove cut out in the drywall to accommodate the profile should be 51mm - 56mm wide
- when mounted in double drywall, the profile does not interfere with the structure

AVAILABLE LENGTHS

Ref. nr.	surface finish	available lengths
C0756ANODA_2	Silver anodized	2000 mm
C0756ANODA_3	Silver anodized	3000 mm

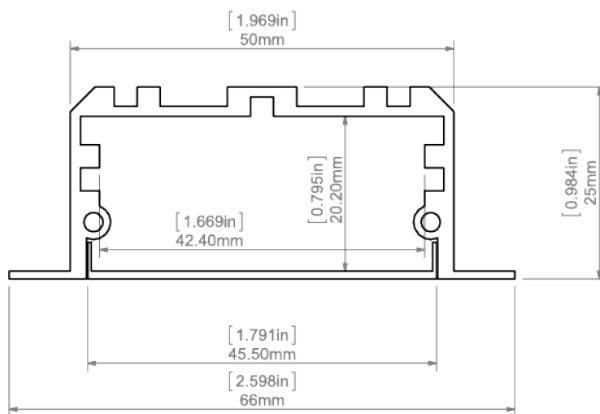
TECHNICAL DRAWING

RELATED PRODUCTS

COVERS

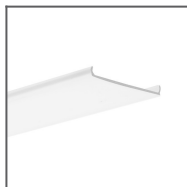

Ref: 17086

END CAPS



Ref: 24298

ACCESSORIES

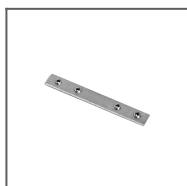

Ref: 42717



Ref: 00838V1

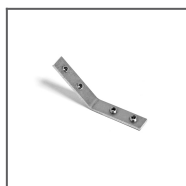

Ref: 42719

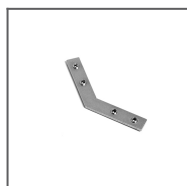

Ref: 42720



Ref: 00802

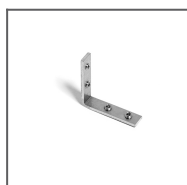

Ref: 42718

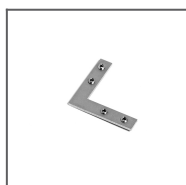

Ref: 42716

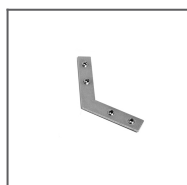

Ref: 42728

COUPLERS - CONNECTION METHODS FOR PROFILES

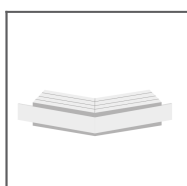

L135

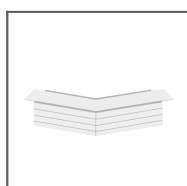

L135PW

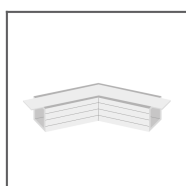

L135PZ

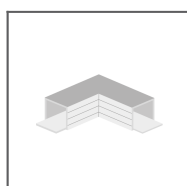

L90



L90PW

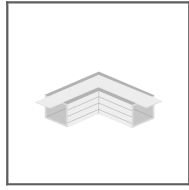

L90PZ

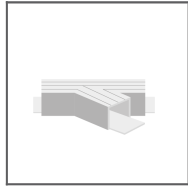

T135L

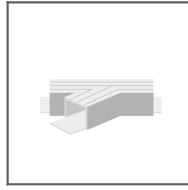

T135R

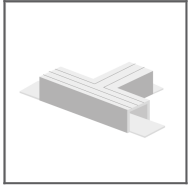

T90



X135



X90